

RESISTOR REMOVAL/INSTALLATION

B3E074061015W01

L.H.D.

1. • Disconnect the negative battery cable.
2. Remove the two nuts securing the cooler hose (LO).
3. Remove the following parts:
 - (1) Front doors (See [FRONT DOOR REMOVAL/INSTALLATION.](#))
 - (2) Console (See [CONSOLE REMOVAL/INSTALLATION.](#))
 - (3) Shift lever component (MTX) (See [SHIFT MECHANISM REMOVAL/INSTALLATION.](#))
 - (4) Selector lever component (ATX) (See [SELECTOR LEVER COMPONENT REMOVAL/INSTALLATION.](#))
 - (5) Decoration panel (See [DECORATION PANEL REMOVAL/INSTALLATION.](#))
 - (6) Front scuff plate (See [FRONT SCUFF PLATE REMOVAL/INSTALLATION.](#))
 - (7) Front side trim (See [FRONT SIDE TRIM REMOVAL/INSTALLATION.](#))
 - (8) Glove compartment (See [GLOVE COMPARTMENT REMOVAL/INSTALLATION.](#))
 - (9) Shower ducts (LH, RH) (See [A/C UNIT REMOVAL/INSTALLATION.](#))
 - (10) PJB (See [PASSENGER JUNCTION BOX \(PJB\) REMOVAL/INSTALLATION.](#))
 - (11) Car-navigation unit (See [CAR-NAVIGATION UNIT REMOVAL/INSTALLATION.](#))
 - (12) Lower panel (See [LOWER PANEL REMOVAL/INSTALLATION.](#))
 - (13) Column cover (See [COLUMN COVER REMOVAL/INSTALLATION.](#))
 - (14) Meter hood (See [METER HOOD REMOVAL/INSTALLATION.](#))
 - (15) Instrument cluster (See [INSTRUMENT CLUSTER REMOVAL/INSTALLATION.](#))
 - (16) Steering shaft (See [STEERING WHEEL AND COLUMN REMOVAL/INSTALLATION.](#))
 - (17) A-pillar trim (See [A-PILLAR TRIM REMOVAL/INSTALLATION.](#))
 - (18) Center panel module (See [CENTER PANEL MODULE REMOVAL/INSTALLATION.](#))
 - (19) LCD unit (See [LCD UNIT REMOVAL/INSTALLATION.](#))
 - (20) Cowl grille (See [COWL GRILLE REMOVAL/INSTALLATION.](#))
 - (21) Cowl panel (See [COWL PANEL REMOVAL/INSTALLATION.](#))
 - (22) Windshield wiper arm and blade (See [WINDSHIELD WIPER ARM AND BLADE REMOVAL/INSTALLATION.](#))
 - (23) Windshield wiper motor (See [WINDSHIELD WIPER MOTOR REMOVAL/INSTALLATION.](#))
4. Disconnect the air mix wire from the air mix link and wire clamp. (Manual air conditioner)
5. Disconnect the airflow mode wire from the airflow mode main link and wire clamp. (Manual air conditioner)
6. Disconnect the following connectors:
 - Blower motor connector
 - Power MOS FET connector (Full-auto air conditioner)
 - Evaporator temperature sensor connector
 - Air intake actuator connector
 - Air mix actuator connector (Full-auto air conditioner)
 - Airflow mode actuator connector (Full-auto air conditioner)
7. Remove the rear heat duct (1).
8. Remove the heater case. (See [A/C UNIT REMOVAL/INSTALLATION.](#))
9. Remove the dashboard. (See [DASHBOARD REMOVAL/INSTALLATION.](#))
10. Move the A/C unit to the right and remove the resistor.

Caution

- While moving the A/C unit, do not apply excessive force. Otherwise it will result in deformation of the refrigerant piping or refrigerant gas leakage.

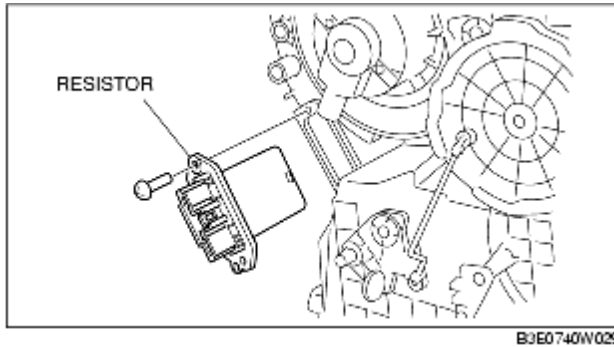

11. Install in the reverse order of removal.

R.H.D.

1. Disconnect the negative battery cable.
2. Remove the following parts:
 - (1) Decoration panel (See [DECORATION PANEL REMOVAL/INSTALLATION.](#))
 - (2) Front scuff plate (See [FRONT SCUFF PLATE REMOVAL/INSTALLATION.](#))
 - (3) Front side trim (See [FRONT SIDE TRIM REMOVAL/INSTALLATION.](#))
 - (4) Glove compartment (See [GLOVE COMPARTMENT REMOVAL/INSTALLATION.](#))
3. Remove in the order indicated in the table.

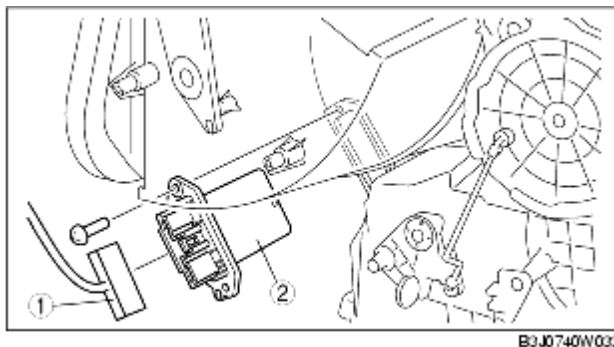

1	Resister connector
2	Resister

4. Install in the reverse order of removal.